

STUDENT WORKSHEET

Analyzing Captain Avery's Inventory

Read through Captain Salem Avery's inventory.

To create an inventory, you walk through a home and make a list of each thing that you see.

Take a look at Captain Salem Avery's inventory.

Which items do you think belong in each room of the Avery's house? Fill in the diagram of the house: write the names of objects in the rooms where you think they belong.

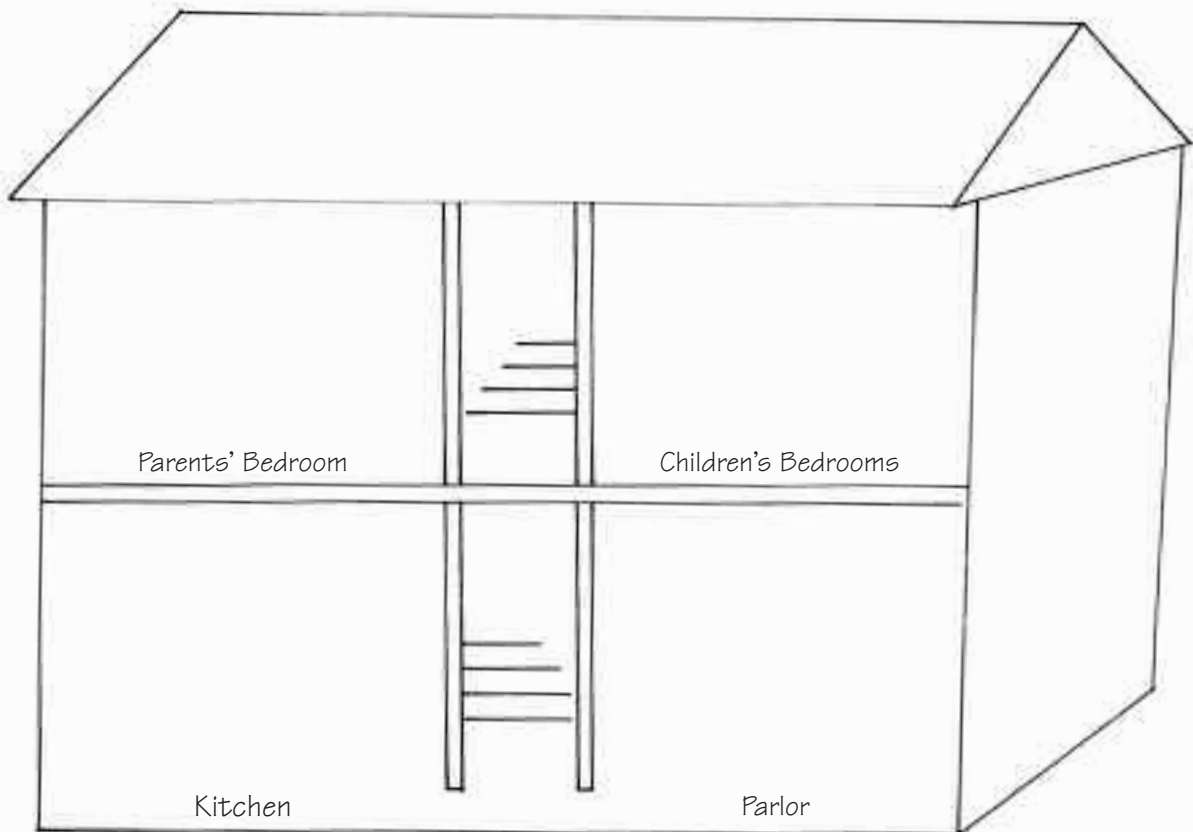

Inventory Math

Calculate:

The total value of Captain Avery's estate: \$ _____

The value of items used in the house: \$ _____

The value of items used to earn a living: \$ _____

Which category of goods was more valuable?

Take another look at the inventory.

Work with a partner or in a small group to:

- Predict what the Avery family did for entertainment.
Give evidence from the inventory for your answer.
-

- Choose an item you think was a luxury item for the Avery family.
-

- Identify some things that are missing from the inventory
(that you would expect to see in Captain Avery's house.).
-
-

Like other 19th century watermen's families, the Avery family made their living in two ways: working the water and farming the land. Based on evidence from the inventory only –

- Predict the main way the Avery family made their living.
-

- How did you think they supplemented their income?
-

- Do you think the inventory gives you a true picture of how the Avery family earned their living? Why or why not?
-
-

Name _____ Date _____

HISTORICAL DOCUMENT

Inventory of Salem Avery's Personal Estate

February 20, 1888

1 Organ & Stove	\$25.00	1 Carriage and Harness	\$30.00
6 Chairs, Straight Back	\$ 6.00	1 Bed Stead Crib	\$ 2.00
1 Rocking Chair	\$ 1.50	6 Chairs, Curve Back	\$ 6.00
1 Sofa	\$ 5.00	1 Combined Desk & Bureau	\$ 2.00
1 Center Table	\$ 1.00	1 Bed Stead, High Back	\$ 5.00
1 Spy Glass	\$ 2.00	1 Single Bed Stead	\$ 1.00
1 Bureau and Glass	\$10.00	1 Sewing Machine	\$10.00
1 Lounge	\$ 3.00	1 Extension Table	\$ 5.00
1 Arm Chair	\$ 1.00	1 Single Set Harness	\$ 5.00
1 Clock	\$ 2.00	1 Wagon Harness	\$10.00
1 Carpet	\$ 3.00	1 Bay Horse (4 years old)	\$60.00
Plates, dishes, glasses	\$ 5.00	1 Light Bay Horse	\$50.00
1 Looking Glass	\$ 1.00	2 Young Cows @ \$20	\$40.00
1 Feather Bed and Stead	\$15.00	1 Older Cow	\$15.00
1 Kitchen Table	\$ 1.00	1 Yoke Oxen	\$50.00
1 Cook Stove and Utensils	\$15.00	1 Red Heifer (Cow)	\$15.00
1 Kitchen Safe	\$ 1.50	2 Calves	\$ 8.00
1 Desk	\$ 2.00	1 Bay Colt (2 years old)	\$40.00
1 Coal Stove (Parlor)	\$20.00	1 Roan Colt (1 year old)	\$25.00
4 Flat Irons	\$ 1.50	8 Sheep	\$24.00
1 Cross Cut Saw	\$ 4.00	1 Dark Roan Mare	\$70.00
Lot of Carpenters Tools	\$ 5.00	1 Ox Cart	\$25.00
12 Crocks	\$ 1.50	2 Small Cultivators	\$ 5.00
9 Jars	\$ 2.25	2 Farmer Plows	\$ 6.00
2 Dish Pans	\$.75	2 Smaller Plows @ \$2.00	\$ 4.00
2 Tin Buckets	\$.25	1 Harrow	\$ 2.00
1 Boat (Golden Rule)	\$600.00	1 Wooden Cultivator	\$ 1.00
1 Horse Wagon	\$35.00	1 Corn Sheller	\$ 4.00

Total amount of appraisal \$ _____

We the subscribers do certify that the foregoing is a just and true inventory and valuation of the personal estate of the said Salem Avery, deceased.

Witness our hand and seals this 20th day of February in the year of our Lord 1888.

George Hyde, Jr. and Thomas C. Phipps – Appraisers

Lucretia Avery, admix.

Historical Document – Salem Avery's Estate Inventory

I Will and perfect Inventory of all and singular the Goods Chattels and Personal Estate of Salem Avery late of Anne Arundel County, deceased appraised by the subscribers George W. Hyde & Thomas St. Phillips jointly we having seen the will of the said deceased and having taken the oath prescribed by law as well in view in the warrant to appraise and certify the same as required by law and approved

12 guns & shot at	\$ 200	1 Bedstead with	2 00
6 Chairs & straight back	100	1 Bedstead same back	100
1 Looking Glass	10	1 Bedstead with 12 drawers	2 00
1 Sofa	50	1 Bedstead High back	5 00
1 Writing Table	10	1 Single Bedstead	1 00
1 new Glass	20	1 Sewing Machine	10 00
1 Bureau and Glass	100	1 Writing Table	5 00
1 Lamp	5 00	1 Single Bedstead with	5 00
1 Arm Chair	1 00	1 Trunk with	10 00
1 Clock	2 00	1 Bay of Iron	10 00
1 Carpet	3 00	1 Light bay of Iron	5 00
Plates dishes glasses	5 00	2 Brass basins	10 00
1 Looking Glass	1 00	1 Bedstead	15 00
1 Chaise Bedstead	15 00	1 Bedstead	5 00
1 Writing Table	1 00	1 Bedstead	15 00
1 Clock with 12 drawers	15 00	2 Chairs	5 00
1 Bedstead	1 00	1 Bay bed (2 1/2 drawers)	10 00
1 Bedstead	2 00	1 Bedstead 1 1/2 drawers	25 00
1 Bedstead (Parlor)	20 00	3 Chairs	20 00
1 Bedstead	1 00	1 Bedstead with	70 00
1 Bedstead	1 00	1 Bedstead	25 00
1 Bedstead	5 00	2 Bedsteads	5 00
1 Bedstead	5 00	2 Bedsteads	20 00
2 Bedsteads	1 00	1 Bedstead	10 00
1 Bedstead	10 00	1 Bedstead	1 00
1 Bedstead	35 00	1 Bedstead	10 00
1 Bedstead	20 00	1 Bedstead	10 00

Total amount of appraisement \$ 2,900 00

We the subscribers do certify that the foregoing is a just and true Inventory and Valuation of all and singular the Goods Chattels and Personal Estate of the said Salem Avery deceased as far as the same has come to our sight and knowledge and we thereof and appraised in dollars and cents according to the best of our skill and judgment

Witness our hands and seals this 20th day of February in the year of our Lord one thousand eight hundred and eighty eight.

George W. Hyde
Thomas St. Phillips

2,900 00